



Universal Sales Timpco® Operators

1045 ARROWSMITH ~ EUGENE, OR 97402 ~ PH (541) 344-4650 ~ FX (541) 344-4699

TIMPCO WORM GEAR OPERATORS

Have a butterfly valve or ball valve that needs a new operator?
These gears can be machined to fit virtually any 90 degree turn valve.

Purchase them with blank bases and pilot bores, or provide us the dimensions, and we can have the machining done for you. They are available in a wide range of gear ratios and torque ratings.

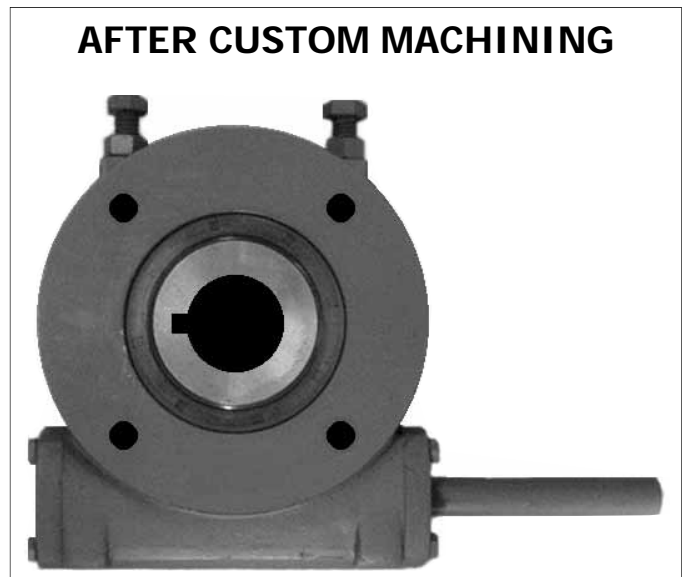
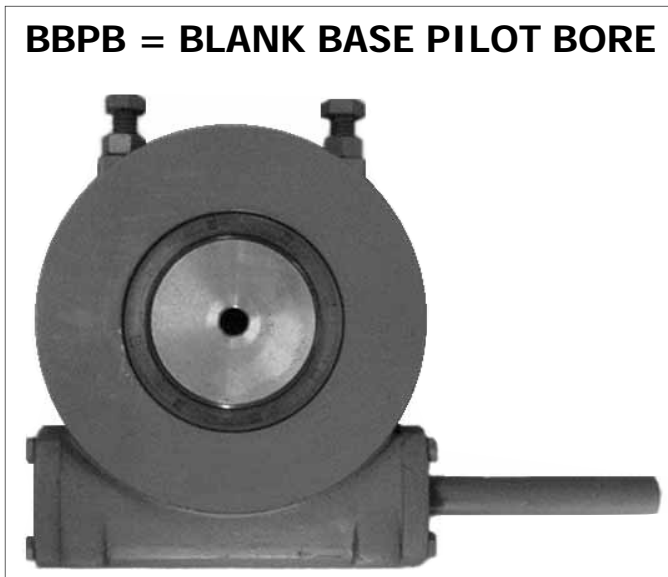

CONSTRUCTION:

Weatherproof housing manufactured from high strength cast iron, protects and isolates internal operating parts from dirt and water. Standard units use gaskets, o-rings, and oil seals.

Carbon steel one piece input shafts are supported by ball bearings or tapered roller bearings for increased efficiency. No sleeve bearings are used.

Durable ductile iron worm gear segments are standard. Optional aluminum bronze worm gear segments are also available. For larger units, ductile iron hubs with aluminum bronze gear teeth are also an option.

External adjusting bolts allow a plus or minus 5 degree range at the end of the gear travel.

The gearbox is permanently lubricated with generous amounts of high quality grease. Zerk type grease fittings are standard for easy routine maintenance.

MOUNTING ADAPTABILITY:

Location, size, and number of tapped mounting holes, as well as bore and keyway dimensions, may be specified by customer. Double D and square shaft bores are also an option. Adapter plates or flanged bases may be used for special or difficult configurations.

HAND WHEELS:

Welded tubular steel, ductile iron, and plastic hand wheels are available in diameters from 6" to 36".



Universal Sales Timpco® Operators

1045 ARROWSMITH ~ EUGENE, OR 97402 ~ PH (541) 344-4650 ~ FX (541) 344-4699

TIMPCO TORQUE RATINGS AND DIMENSIONS

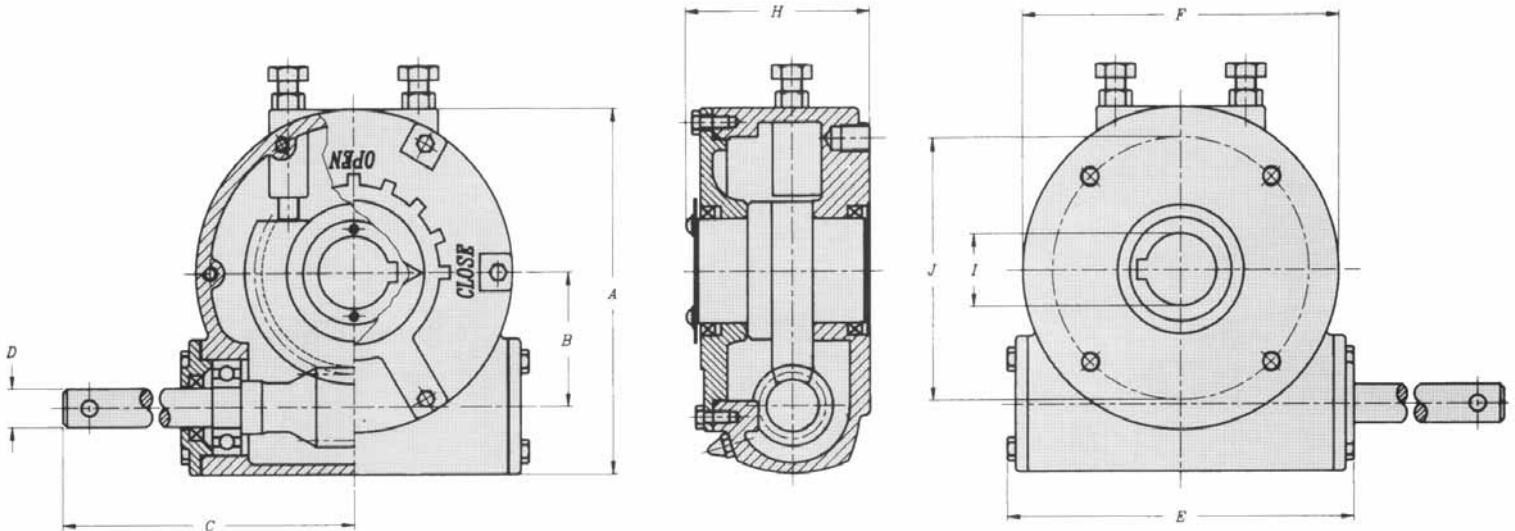

TIMPCO MODEL NUMBER	TORQUE RATING INCH LBS	DIMENSIONS IN INCHES								BORE SIZE		BOLT CIRCLE		TYPICAL BOLT THREAD	WGT LBS
		RATIO	A	B	C	D	E	F	H	MIN	MAX	MIN	MAX		
										I	I	J	J		
TWGO-0	2,000	20:1	4 9/16	1 5/8	4 23/32	19/32	4 7/16	3 7/8	2 15/16	1/2	3/4	2 1/4	3 3/16	5/16-18	9
TWGO-1	3,500	30:1	5 7/32	2	6 19/32	19/32	4 7/8	4 13/32	2 3/4	1/2	1 1/2	2 13/16	4 1/2	3/8-16	11
TWGO-1F	3,500	30:1	5 7/32	2	6 19/32	19/32	4 7/8	4 13/32	2 3/4	1/2	1 1/2	2 13/16	5	3/8-16	12
TWGO-2	8,000	30:1	6 29/32	2 9/16	8 1/32	3/4	6 9/16	6 3/32	3 5/8	3/4	1 7/16	3 1/16	5	3/8-16	19
TWGO-3	13,000	50:1	7 29/32	3 5/32	8	3/4	6 23/32	6 27/32	3 29/32	3/4	2 1/4	4 21/32	5 15/16	1/2-13	27
TWGO-3F	13,000	50:1	8 13/16	3 5/32	8	3/4	6 23/32	8 3/4	3 29/32	3/4	2 1/4	4 21/32	7 3/4	1/2-13	29
TWGO-3.6	17,000	40:1	9 13/32	3 5/8	8 1/2	1	8 3/16	8 3/16	4 29/32	1	2 3/4	5 1/2	7	3/4-10	49
TWGO-4	24,000	80:1	11 1/4	4 5/8	10 1/32	1	9 1/4	9 15/16	4 25/32	1	3 1/4	6 1/2	8	3/4-10	66
TWGO-5	40,000	64:1	11 5/8	4 23/32	10 15/16	1	9 27/32	9 27/32	4 3/4	1	3 1/4	6 1/2	8 1/4	5/8-11	76
TWGO-5A	40,000	58:1	11 5/8	4 11/16	10 3/64	1	9 27/32	9 27/32	4 3/4	1	4	7 1/2	8 1/4	1/2-13	83
TWGO-5F	40,000	64:1	12 13/64	4 23/32	10	1	9 27/32	11 7/8	5 9/32	1	4	6 1/2	10 1/4	5/8-11	87
TWGO-6	50,000	48:1	12 17/32	5 5/32	11 7/32	1 1/8	10 13/32	10 27/32	4 7/8	1	4	6 1/2	9 1/2	5/8-11	77
TWGO-6F	50,000	48:1	12 17/32	5 5/32	11 7/32	1 1/8	10 13/32	11 13/16	4 7/8	1	4	6 1/2	10 5/8	5/8-11	88
TWGO-7	80,000	64:1	17 7/16	7 1/4	11 15/16	1 1/2	14 27/32	15 3/8	6 1/8	3	5 1/2	8 5/8	14 1/4	5/8-11	194
TWGO-9	140,000	59:1	21 13/16	9 3/8	13	1 3/4	15 3/4	19 17/32	6 11/16	4	6 1/2	10 1/4	18	1-8	342

OTHER OPTIONS INCLUDE:

HELICAL INPUTS
SPECIAL RATIOS
ACTUATOR MOUNTING BRACKETS

BURIED SERVICE
SUBMERGED SERVICE
STEEL HAND WHEELS

LIMIT SWITCHES
TAMPER SWITCHES
POSITION INDICATORS